

GENERAL ILLUSTRATION FOR CONSTRUCTING A GARDEN SHED

This 8 x 12 ft shed features a simple gable roof, double doors, and side and rear windows for natural lighting. With full-height walls and doors, there's ample room for storing large items or creating a comfortable work space. An optional wood ramp helps in moving lawn mowers and other heavy equipment.

The finish materials for the basic shed are asphalt roof shingles, plywood siding (T-111) and simple trim details. You can purchase prehung doors or build your own and purchase windows if desired.

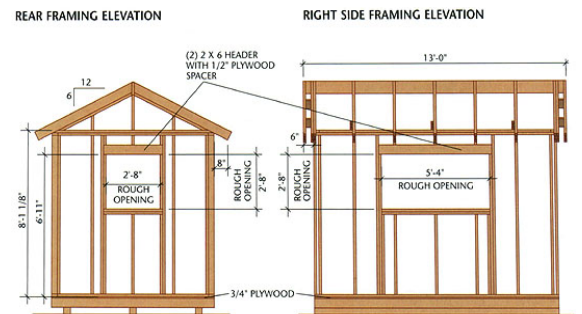
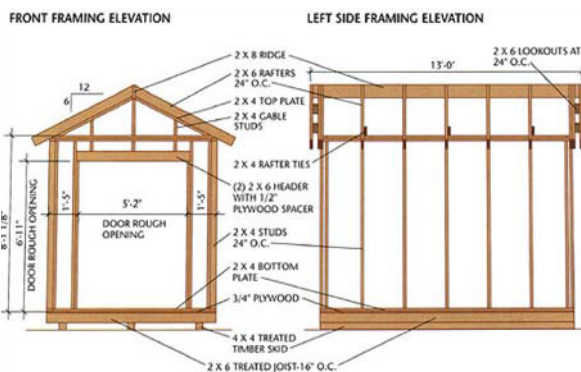

BUILDING SECTION

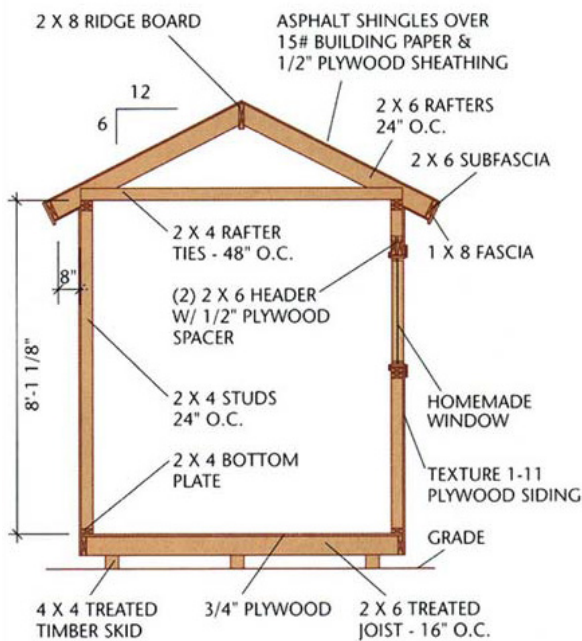

RAFTER TEMPLATE

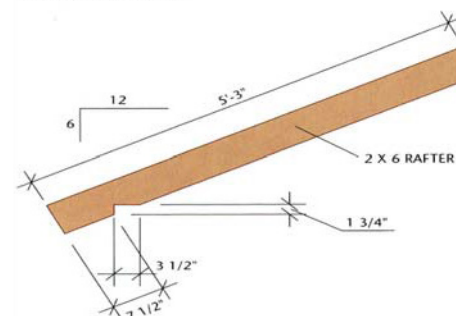

EAVE DETAIL

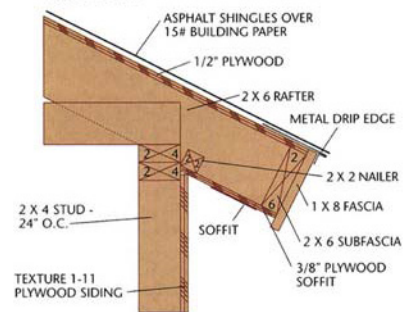

Please Note: Contact the Provo City Building Inspection Division at 801 852 6452 or at 330 W 100 S to determine if a building permit will be required before you start construction.

FLOOR FRAMING PLAN

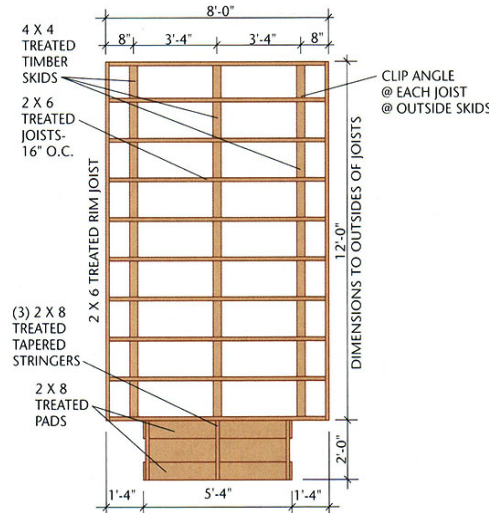

FLOOR PLAN

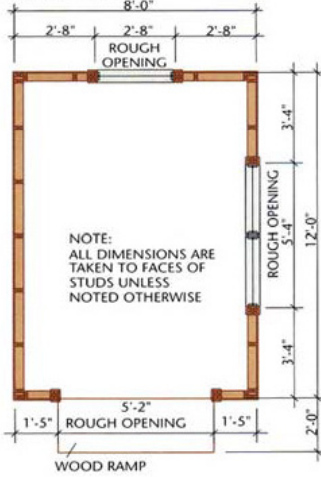

GABLE OVERHANG DETAIL

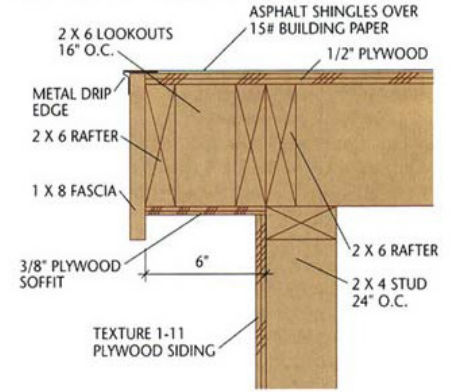

DOOR JAMB DETAIL

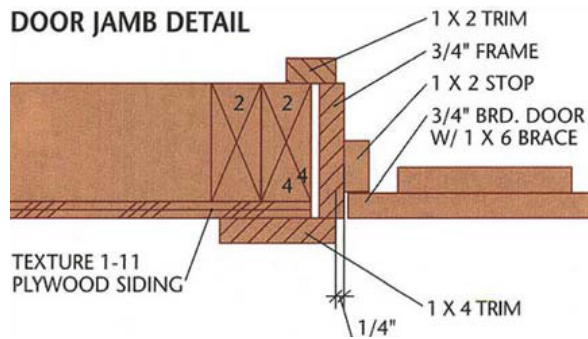

WINDOW JAMB DETAIL

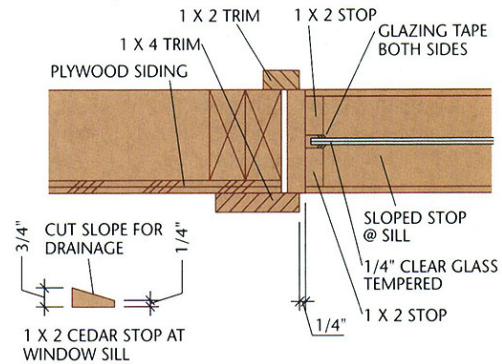

REAR ELEVATION



RIGHT SIDE ELEVATION

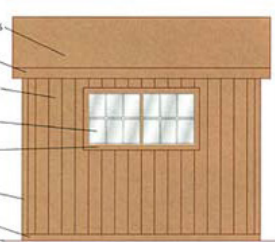

FRONT ELEVATION



LEFT SIDE ELEVATION

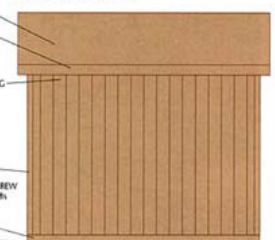

Please Note: Contact the Provo City Building Inspection Division at 801 852 6452 or at 330 W 100 S to determine if a building permit will be required before you start construction.